

# ACME-SHOREY

PRECAST CONCRETE PRODUCTS

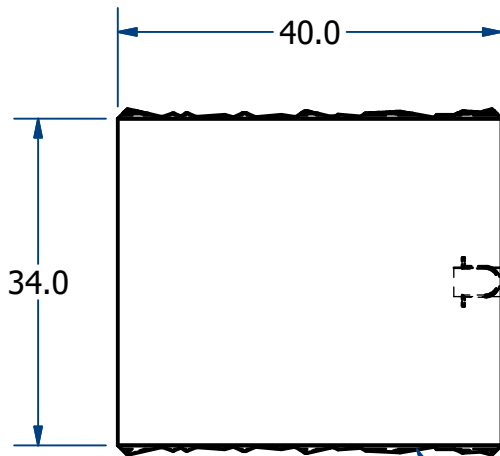

LIMESTONE TEXTURE  
(FRONT & BACK)

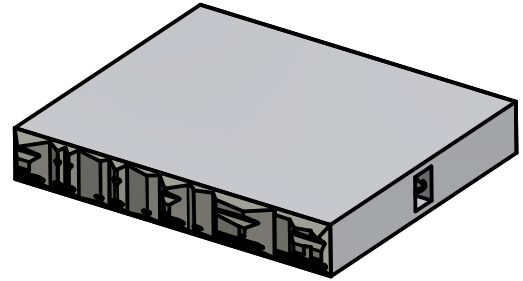
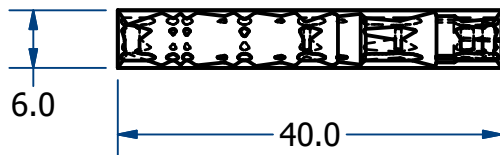

1/4" GALVANIZED  
LIFTING HOOK  
(RECESSED)



**NAME: 6" CAP BLOCK (LB42)**

**H-20**

**ITEM# LB6CB**

Concrete Minimum Strength: 5,000 p.s.i. at 28 days  
Steel Reinforcement: ASTM A615, Grade 60  
Design Loading: standard units - AASHTO - H20

WEIGHT 740

Lbs

C

DATE: 3-21-21

Ch 20 Pg 1.7 Sht 2 of 2